

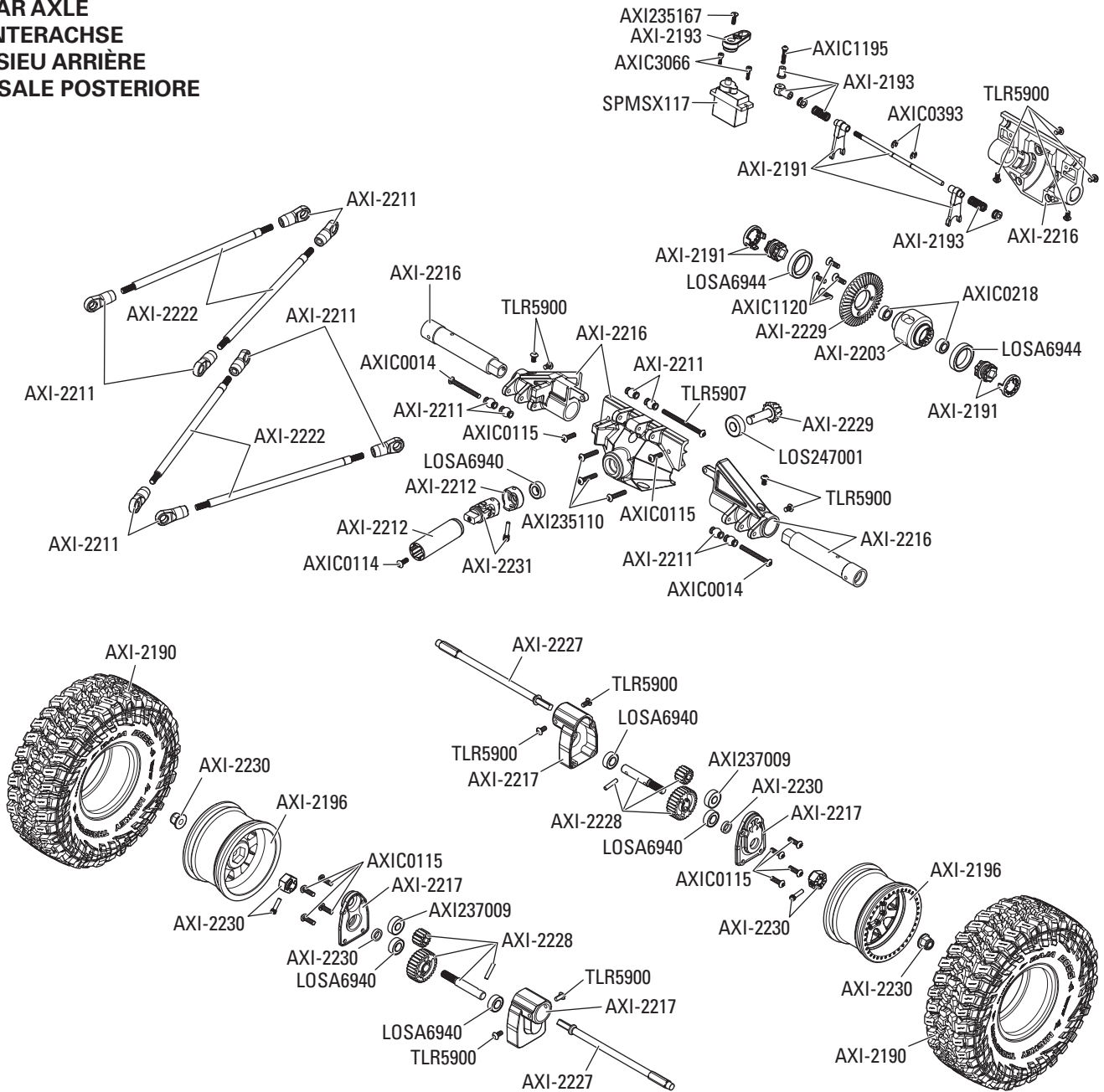

**EXPLODED VIEWS // EXPLOSIONSZEICHNUNGEN // VUES ÉCLATÉES // VISTE ESPLOSE**

**REAR AXLE  
HINTERACHSE  
ESSIEU ARRIÈRE  
ASSALE POSTERIORE**



## EXPLODED VIEWS // EXPLOSIONSZEICHNUNGEN // VUES ÉCLATÉES // VISTE ESPLOSE

### TRANSMISSION GETRIEBE TRANSMISSION TRASMISSIONE

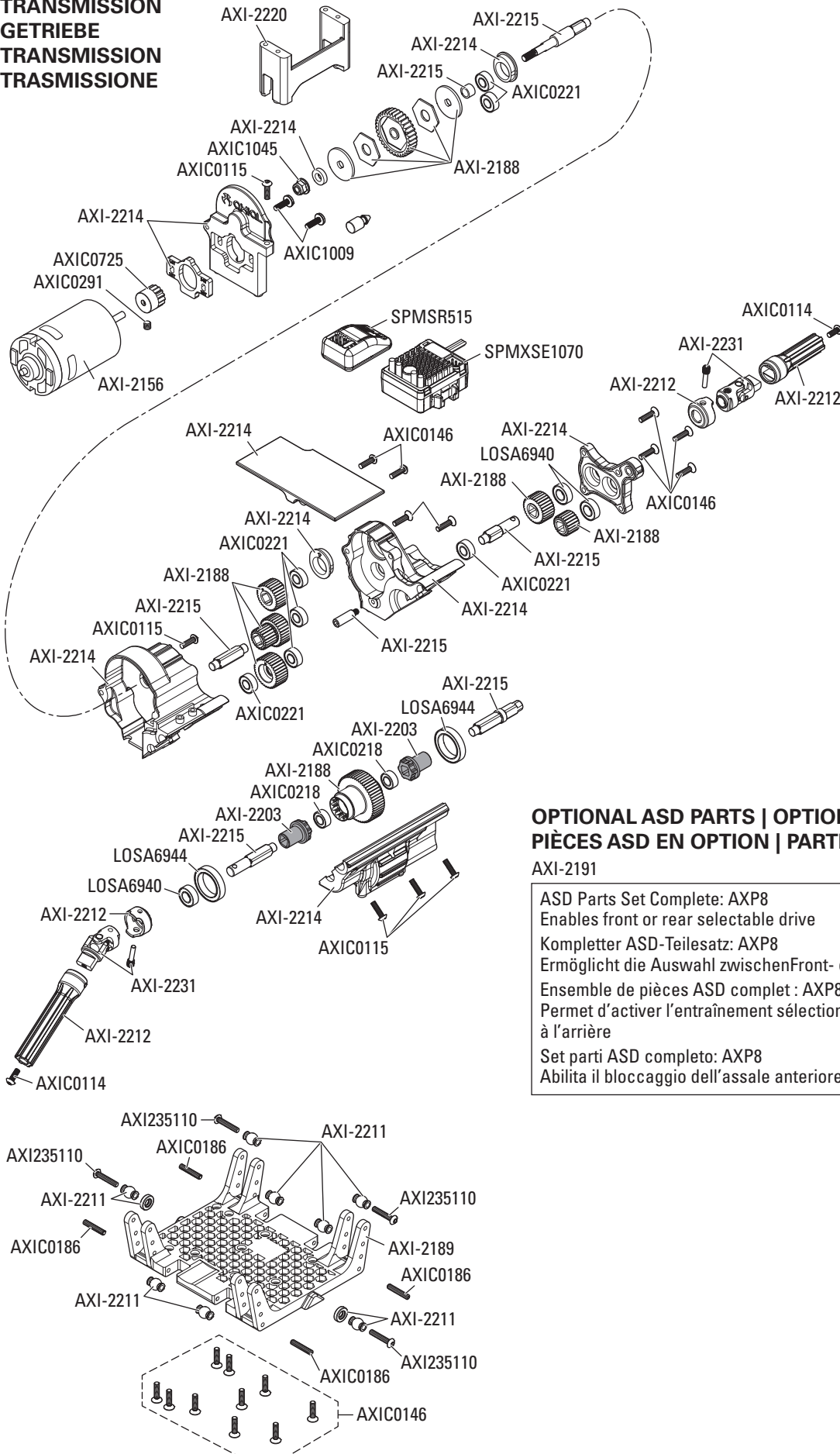

### OPTIONAL ASD PARTS | OPTIONALE ASD-TEILE | PIÈCES ASD EN OPTION | PARTI ASD OPZIONALI

AXI-2191

ASD Parts Set Complete: AXP8  
Enables front or rear selectable drive  
Kompletter ASD-Teilesatz: AXP8  
Ermöglicht die Auswahl zwischen Front- oder Heckantrieb  
Ensemble de pièces ASD complet : AXP8  
Permet d'activer l'entraînement sélectionnable à l'avant ou à l'arrière  
Set parti ASD completo: AXP8  
Abilita il bloccaggio dell'assale anteriore o posteriore

**EXPLODED VIEWS // EXPLOSIONSZEICHNUNGEN // VUES ÉCLATÉES // VISTE ESPLOSE**

**CHASSIS  
KAROSSERIE  
CHÂSSIS  
TELAIO**

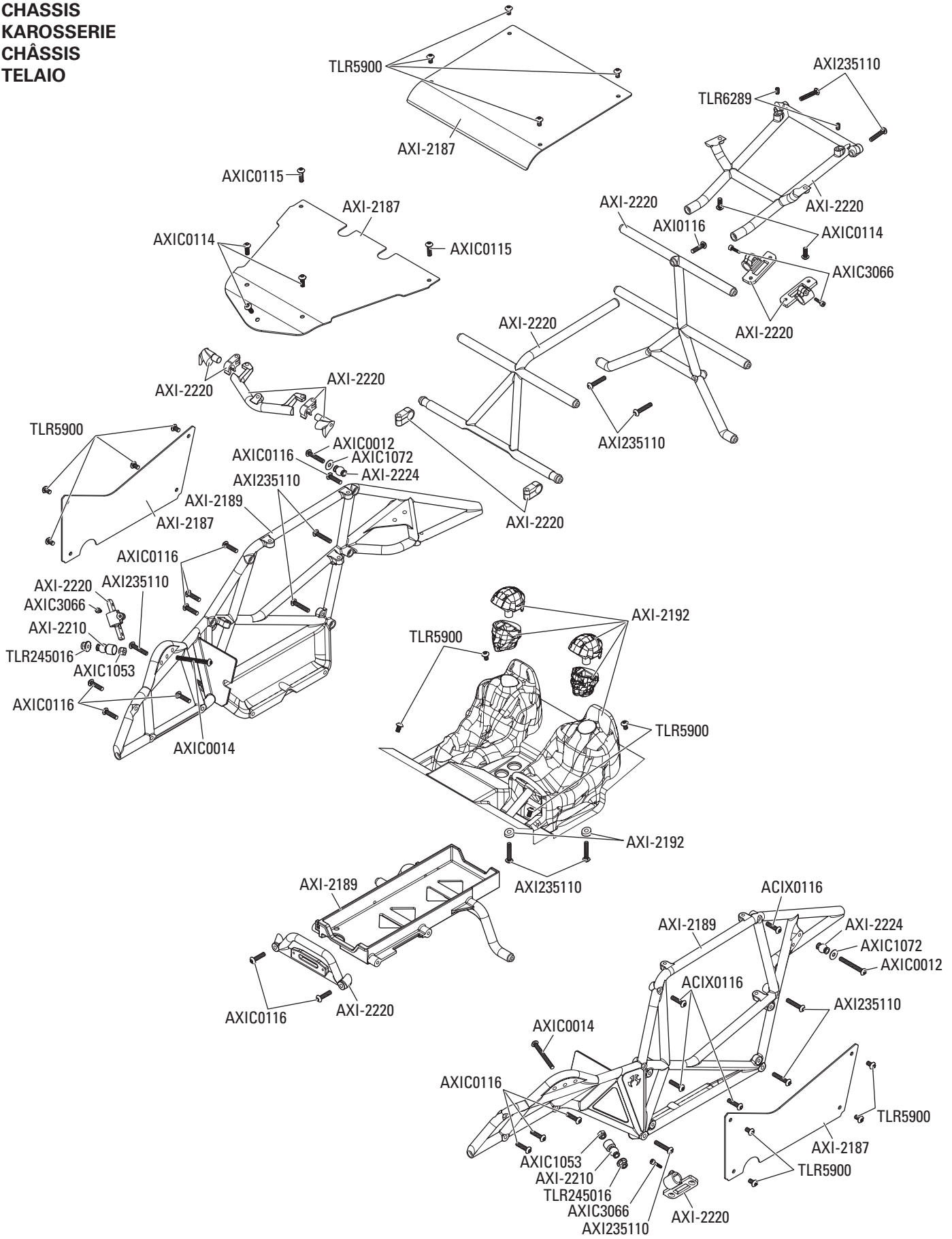

## EXPLODED VIEWS // EXPLOSIONSZEICHNUNGEN // VUES ÉCLATÉES // VISTE ESPLOSE

### SHOCK ABSORBERS STOSSDÄMPFER AMORTISSEURS AMMORTIZZATORI

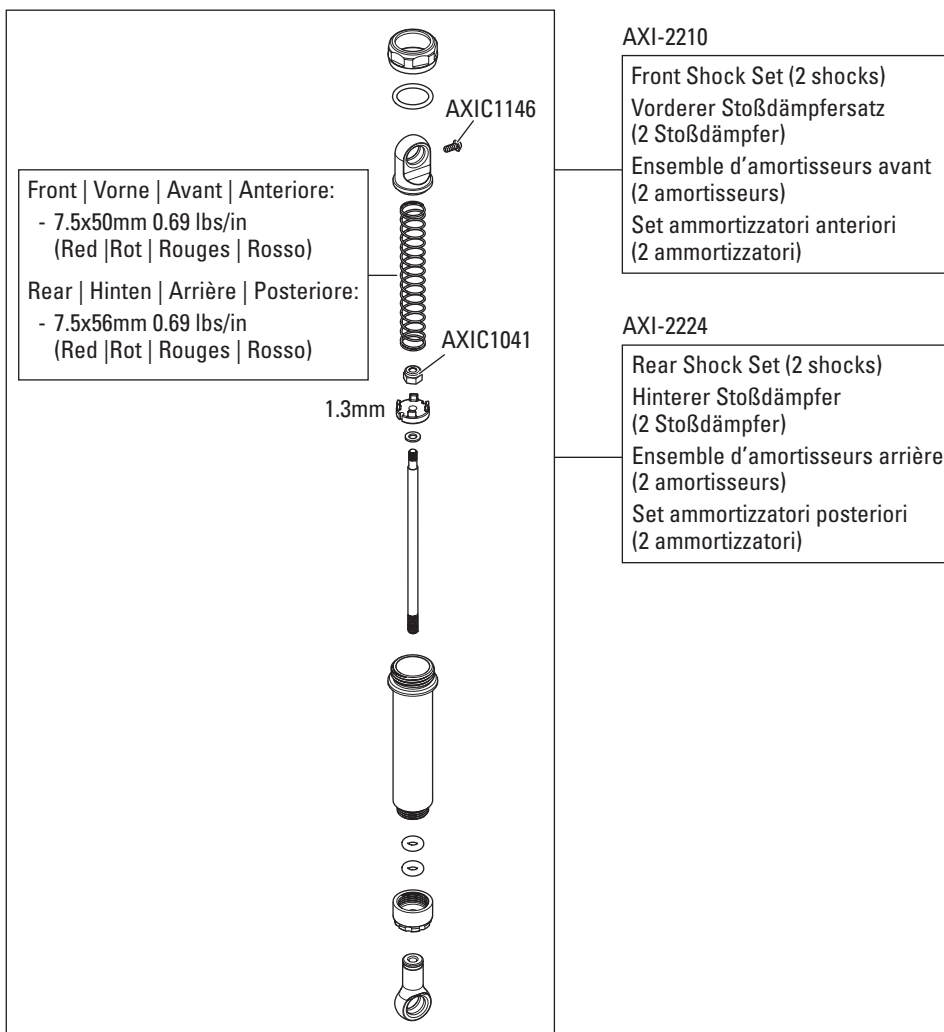

### AXI-2225

#### Shock Tuning and Rebuild Kit

Includes 2 of each:

- Pistons: 1.3, 1.4, 1.5
- Springs:
  - 7.5x50mm 0.69 lbs/in Red (2)
  - 7.5x50mm 0.91 lbs/in Green (2)
  - 7.5x56mm 0.69 lbs/in Red (2)
  - 7.5x56mm 0.91 lbs/in Green (2)
  - 7.5x62mm 0.69 lbs/in Red (2)
  - 7.5x62mm 0.91 lbs/in Green (2)
- Replacement O-Rings

#### Stoßdämpfer Tuning und Umbausatz

Enthält jeweils 2 Stück:

- Kolben: 1.3, 1.4, 1.5
- Federn:
  - 7,5 x 50 mm 0,69 lbs/in Rot (2)
  - 7,5 x 50 mm 0,91 lbs/in Grün (2)
  - 7,5 x 56 mm 0,69 lbs/in Rot (2)
  - 7,5 x 56 mm 0,91 lbs/in Grün (2)
  - 7,5 x 62 mm 0,69 lbs/in Rot (2)
  - 7,5 x 62 mm 0,91 lbs/in Grün (2)
- Ersatz-O-Ringe

#### Ensemble de reconstruction et de réglage des amortisseurs

Comprend 2 exemplaires de chaque :

- Pistons : 1,3 / 1,4 / 1,5
- Ressorts:
  - 7,5 x 50 mm 0,08 Nm (0,69 lb-po), rouges (2)
  - 7,5 x 50 mm 0,1 Nm (0,91 lb-po), jaunes (2)
  - 7,5 x 56 mm 0,08 Nm (0,69 lb-po), rouges (2)
  - 7,5 x 56 mm 0,1 Nm (0,91 lb-po), verts (2)
  - 7,5 x 62 mm 0,08 Nm (0,69 lb-po), rouges (2)
  - 7,5 x 62 mm 0,1 Nm (0,91 lb-po), verts (2)
- Joints toriques de rechange

#### Kit tuning e ricostruzione ammortizzatori

Include 2 di ciascuno:

- Pistoni: 1,3; 1,4; 1,5
- Molle:
  - 7,5x50 mm 0,69 lb/in Rosso (2)
  - 7,5x50 mm 0,91 lb/in Verde (2)
  - 7,5x56 mm 0,69 lb/in Rosso (2)
  - 7,5x56 mm 0,91 lb/in Verde (2)
  - 7,5x62 mm 0,69 lb/in Rosso (2)
  - 7,5x62 mm 0,91 lb/in Verde (2)
- O-ring di ricambio



**PARTS LISTS // TEILELISTEN // LISTE DES PIÈCES // ELENCO COMPONENTI**

Part #	Description	Beschreibung	Description	Descrizione
AXI-2156	Boulder 550, 21T Brushed Electric Motor	550 21T Elektromotor	550 Moteur électrique 21T	550 Motore elettrico 21T
AXI-2187	Body Panel Set, Clear: Gilamon AXP8	Karosserieteilesatz, farblos: Gilamon AXP8	Ensemble de panneaux de carrosserie, transparent : Gilamon AXP8	Set pannelli carrozzeria, trasparente: Gilamon AXP8
AXI-2188	Gear Set, Transmission, AT6: AXP8	Zahnradsatz, Getriebe, AT6: AXP8	Ensemble de train, transmission, AT6 : AXP8	Set ingranaggi, trasmissione, AT6: AXP8
AXI-2189	Cage Sides, Skid Plate, Battery Tray: Gilamon AXP8	Seitenteile Überrollkäfig, Motorschutz, Akkufach: Gilamon AXP8	Côtés de cage, plaque de protection, support de batterie : Gilamon AXP8	Lati gabbia, piastra salvatelaio, vassoio batteria: Gilamon AXP8
AXI-2190	2.2" Mickey Thompson Baja Boss Tires (2)	2.2" Mickey Thompson Baja Boss-Reifen (2)	Pneus Mickey Thompson Baja Boss 5,6 cm (2)	Ruote Boss Baja Mickey Thompson da 2,2" (2)
AXI-2191	ASD Parts Set Complete: AXP8	Kompletter ASD-Teilesatz: AXP8	Ensemble de pièces ASD complet : AXP8	Set parti ASD completo: AXP8
AXI-2192	Interior Set, Clear: Gilamon AXP8	Innensatz, farblos: Gilamon AXP8	Ensemble intérieur, transparent : Gilamon AXP8	Set interni, trasparenti: Gilamon AXP8
AXI-2193	ASD Shift Servo Parts: AXP8	ASD-Schalt servo-Teile: AXP8	Pièces de rechange pour servo ASD : AXP8	Parti servo cambio ASD: AXP8
AXI-2196	2.2" Raceline Avenger Wheels (2)	2.2" Raceline Avenger Reifen (2)	Roues Raceline Avenger 5,6 cm (2)	Cerchi 2.2" Raceline Monster (2)
AXI-2203	ASD Internal Lockout and Spool: AXP8	ASD Interne Verriegelung und Spule: AXP8	Bobine et verrouillage interne ASD : AXP8	Spool e blocco interno ASD: AXP8
AXI-2206	Steering Axle, Assembled, AF16P: AXP8	Lenkungsachse, montiert, AF16P: AXP8	Essieu de direction, assemblé, AF16P : AXP8	Assale di sterzo, assemblato, AF16P: AXP8
AXI-2210	Shock Set Complete, Front, IS10: AXP8	Stoßdämpfersatz komplett, vorne, IS10: AXP8	Ensemble d'amortisseurs complet, avant, IS10 : AXP8	Set ammortizzatori completo, anteriore, IS10: AXP8
AXI-2211	Rod Ends Set (20): AXP8	Stangenkopfsatz (20): AXP8	Ensemble d'embouts de bielle (20) : AXP8	Set teste a snodo (20): AXP8
AXI-2212	WB12 Driveshaft Set, Front/Rear: AXP8	WB12 Antriebswellensatz, vorne/hinten: AXP8	Ensemble d'arbre de transmission WB12, avant/arrière : AXP8	WB12 Set albero trasmissione, ant./post.: AXP8
AXI-2214	Transmission Housing Set, AT6: AXP8	Getriebegehäusesatz, AT6: AXP8	Ensemble boîte de transmission, AT6 : AXP8	Set alloggiamento trasmissione, AT6: AXP8
AXI-2215	Transmission Shaft Set, AT6: AXP8	Getriebewellensatz, AT6: AXP8	Ensemble arbre de transmission, AT6 : AXP8	Set albero trasmissione, AT6: AXP8
AXI-2216	Axle Housing, Rear, AF16P: AXP8	Achsgehäuse, hinten, AF16P: AXP8	Carter d'essieu, arrière, AF16P : AXP8	Alloggiamento assale, posteriore, AF16P: AXP8
AXI-2217	Portal Box, Rear, AF16P: AXP8	Portalbox, hinten, AF16P: AXP8	Boîte de portique, arrière, AF16P : AXP8	Portal Box, posteriore, AF16P: AXP8
AXI-2218	Portal Box, Front, AF16P: AXP8	Portalbox, vorne, AF16P: AXP8	Boîte de portique, avant, AF16P : AXP8	Portal Box, anteriore, AF16P: AXP8
AXI-2219	Axle Housing, Front, AF16P: AXP8	Achsgehäuse, vorne, AF16P: AXP8	Carter d'essieu, avant, AF16P : AXP8	Alloggiamento assale, anteriore, AF16P: AXP8
AXI-2220	Cage Parts Details: Gilamon AXP8	Teile Überrollkäfig Details: Gilamon AXP8	Détails des pièces de la cage : Gilamon AXP8	Dettagli parti gabbia: Gilamon AXP8
AXI-2221	Front Links, Upper/Lower, Steel: AXP8	Vordere obere/untere Stangen, Stahl: AXP8	Bras avant, supérieur/inférieur, en acier : AXP8	Tiranti anteriori, sup./inf., acciaio: AXP8
AXI-2222	Rear Links, Upper/Lower, Steel: AXP8	Hintere obere/untere Stangen, Stahl: AXP8	Bras arrière, supérieur/inférieur, en acier : AXP8	Tiranti posteriori, sup./inf., acciaio: AXP8
AXI-2223	Steering Links, Steel, AF16P: AXP8	Lenkstangen, Stahl, AF16P: AXP8	Tringleries de direction, en acier, AF16P : AXP8	Tiranti sterzo, acciaio, AF16P: AXP8
AXI-2224	Shock Set Complete, Rear, IS10: AXP8	Stoßdämpfersatz komplett, hinten, IS10: AXP8	Ensemble d'amortisseurs complet, arrière, IS10 : AXP8	Set amm. completo, posteriore, IS10: AXP8
AXI-2225	Shock Tuning and Rebuild Kit, IS10: AXP8	Stoßdämpfer Tuning und Umbausatz, IS10: AXP8	Ensemble de reconstruction et de réglage des amortisseurs, IS10 : AXP8	Kit tuning e ricostruzione ammortizzatori, IS10: AXP8
AXI-2226	Universal Axle Set, AF16P: AXP8	Universalachsensatz, AF16P: AXP8	Ensemble essieu universel, AF16P : AXP8	Set assale universale, AF16P: AXP8
AXI-2227	Straight Axle Set, AF16P: AXP8	Gerader Achsensatz, AF16P: AXP8	Ensemble essieu droit, AF16P : AXP8	Set assale dritto, AF16P: AXP8
AXI-2228	32P Portal Gears, 13/28T, AF16P: AXP8	32P Portal-Getriebe, 13/28T, AF16P: AXP8	Engrenages de portique 32P, 13/28T, AF16P : AXP8	Ingranaggi Portal 32P, 13/28T, AF16P: AXP8
AXI-2229	32P Ring/Pinion 13/43T: AXP8	32P Ring/Ritzel 13/43T: AXP8	Anneau/pignon 32P, 13/43T : AXP8	Corona/Pignone 32P 13/43T: AXP8

Part #	Description	Beschreibung	Description	Descrizione
AXI-2230	12mm Hex Hub Set (4): AXP8	12 mm Sechskantnabensatz (4): AXP8	Ensemble moyeu hexagonal 12 mm (4) : AXP8	Set mozzi esagonali 12 mm (4): AXP8
AXI-2231	WB12 Driveshaft Coupler Set: AXP8	WB12 Antriebswellenkupplungssatz: AXP8	Ensemble coupleur d'arbre de transmission WB12 : AXP8	WB12 Set acc. albero trasmissione: AXP8
AXI-2232	Multi-Color LED Rock Lights w/ Controller	Mehrfarbige LED-Geländescheinwerfer mit Steuergerät	Système d'éclairage multicolore à DEL Rock Lights avec contrôleur	Luci LED Rock multicolore con controller
AXI235109	M3 x 14mm Button Head Screw (10)	Rundkopfschraube, M3x14mm (10)	Vis à tête bombée, M3x14mm (10)	Vite a testa tonda M3x14mm (10)
AXI235110	M3 x 16mm Button Head Screw (10)	Rundkopfschraube, M3x16mm (10)	Vis à tête bombée, M3x16mm (10)	Vite a testa tonda M3x16mm (10)
AXI235167	M2.5 x 8mm Flat Head Screw (10)	Flachkopfschraube, M2,5x8mm (10)	Vis à tête plate, M2,5x8mm (10)	Vite a testa piana M2,5x8mm (10)
AXI236103	2.5mm x 4.6mm x 0.5mm Washer (10)	2,5x4,6x0,5mm Unterlegscheibe (10)	Rondelle, 2,5x4,6x0,5mm (10)	Rondelle 2,5x4,6x0,5mm (10)
AXI237009	5x13x4mm Ball Bearing (2)	5x13x4mm Kugellager (2)	Roulement 5x13x4mm (2)	Cuscinetti 5x13x4mm (2)
AXIC0005	Hex Socket Button Head Black M3x6mm (10)	Sechskant-Rundkopfschraube M3x6mm	Douille à six pans à tête bombée M3x6mm	Vite a testa tonda con esagono incassato M3x6mm
AXIC0012	Hex Socket Button Head M3x25mm Black (10)	Sechskant-Rundkopfschraube M3x25mm	Douille à six pans à tête bombée M3x25mm	Vite a testa tonda con esagono incassato M3x25mm
AXIC0014	AXA121 Hex Socket Button Head M3x30mm Black (10)	Sechskant-Rundkopfschraube M3x30mm	Douille à six pans à tête bombée M3x30mm	Vite a testa tonda con esagono incassato M3x30mm
AXIC0114	Hex Socket Button Head 3x8mm (10)	Sechskant-Rundkopfschraube M3x8mm	Douille à six pans à tête bombée M3x8mm	Vite a testa tonda con esagono incassato M3x8mm
AXIC0115	Hex Socket Button Head M3x10mm Black (10)	Sechskant-Rundkopfschraube M3x10mm	Douille à six pans à tête bombée M3x10mm	Vite a testa tonda con esagono incassato M3x10mm
AXIC0116	Hex Socket Button Head M3x12mm Black (10)	Sechskant-Rundkopfschraube M3x12mm	Douille à six pans à tête bombée M3x12mm	Vite a testa tonda con esagono incassato M3x12mm
AXIC0146	Hex Socket Flat Head M3x12mm Black (10)	Sechskant-Flachkopfschraube, M3x12mm	Douille à six pans à tête plate M3x12mm	Vite a testa piana con esagono incassato M3x12mm
AXIC0186	AXA186 Set Screw M3x16mm Black Oxide (10)	Stellschraube, M3x16mm, Schwarzoxid (10)	Vis de fixation M3x16mm brunie (10)	Vite di fermo M3x16mm ossido nero (10)
AXIC0218	Bearing 5x10x4mm (2)	Lager 5x10x4mm	Roulement 5x10x4mm	Cuscinetto 5x10x4mm
AXIC0221	Bearing 5x11x4mm (2)	Lager 5x11x4mm	Roulement 5x11x4mm	Cuscinetto 5x11x4mm
AXIC0230	Bearing 10x15x4mm	Lager 10x15x4mm	Roulement 10x15x4mm	Cuscinetto 10x15x4mm
AXIC0291	AXA291 Set Screw M4x4mm Black Oxide (6)	Stellschraube, M4x4mm, Schwarzoxid (6)	Vis de fixation M4x4mm brunie (6)	Vite di fermo M4x4 mm ossido nero (6)
AXIC0393	AXA1393 E-Clip E2.5 (10)	E-Clip, 2,5mm	E-Clip, 2,5mm	E-Clip, 2,5mm
AXIC1041	AXA1041 Nylon Locknut 2.5 (10)	2.5 Sicherungsmuttern (10)	Contre-écrous 2.5 (10)	Dadi 2.5 (10)
AXIC1045	AXA1045 Nylon Locknut M4 Black (10)	M4 Sicherungsmuttern (10)	Contre-écrous M4 (10)	Dadi M4 (10)
AXIC1053	AXA1053 Nylon Locking Hex Nut M3 Black (10)	M3 Sicherungsmuttern (10)	Contre-écrous M3 (10)	Dadi M3 (10)
AXIC1072	AXA1072 Washer 3x8x0.5mm (10)	3x8x0.5mm Unterlegscheibe (10)	Rondelle, 3x8x0.5mm (10)	Rondelle 3x8x0.5mm (10)
AXIC1120	Hex Socket Flat Head 3x10mm (10)	Sechskant-Flachkopfschraube, M3x10mm	Douille à six pans à tête plate M3x10mm	Vite a testa piana con esagono incassato M3x10mm
AXIC1146	AX31146 Hex Sckt Button Hd Screw M2x4mm Black (10)	Sechskant-Rundkopfschraube M2x4mm (10)	Douille à six pans à tête bombée M2x4mm (10)	Vite a testa tonda con esagono incassato M2x4mm (10)
AXIC1195	AX31195 Hex Socket Button Head 2.6x12mm (10)	Sechskant-Rundkopfschraube 2.6x12mm (10)	Douille à six pans à tête bombée 2.6x12mm (10)	Vite a testa tonda con esagono incassato 2.6x12mm (10)
AXIC1391	AXA1391 E4 E-Clip (10)	E-Clip, 4mm	E-Clip, 4mm	E-Clip, 4mm
AXIC1495	AX31495 Bearing 8x12x3.55mm (2)	8x12x3.55mm Kugellager (2)	Roulement 8x12x3.55mm (2)	Cuscinetti 8x12x3.55mm (2)
AXIC3066	Cap Head M2x8mm Black (10)	Inbusschraube M2x8mm, schwarz (10)	Vis d'assemblage creuse M2x8mm noire (10)	Vite a testa cilindrica M2x8mm nero (10)
LOS235015	Lock Nut, Flanged M5 x 0.8 Serrated (10)	Nylon-Feststellflanschmutter, M5 x 0.8 (10)	Contre-écrou en nylon strié M5 x 0.8 (10)	Dato flangiato Nylock nero M5 x 0.8 (10)
LOS247001	6x15x5mm Metal Shield Ball Bearing (4)	6x15x5mm Kugellager (4)	Roulement 6x15x5mm (4)	Cuscinetti 6x15x5mm (4)
LOSA6940	6x12x4mm Sealed Ball Bearing (4)	6x12x4mm abgedichtetes Kugellager (4)	Roulement à billes hermétique 6x12x4mm (4)	Cuscinetti a sfera sigillato 6x12x4mm (4)
LOSA6944	15 x 21 x 4 Shielded Ball Bearing(2)	15x21x4mm abgedichtetes Kugellager (2)	Roulement à billes hermétique 15x21x4mm (2)	Cuscinetti a sfera sigillato 15x21x4mm (2)
SPMR2340T	DX3 SMART Tx with Thumb Steer	DX3 SMART 3CH Sender	DX3 Smart 3CH Émetteur	DX3 Smart 3CH Trasmettitore
SPMS682	S682 - 20kg servo , steel gear 25T	S682 - 20kg Metallgetriebeservo, 25T	Servo à engrenages métalliques S682 - 20kg 25T	S682 - 20kg Servo, ingranaggio metallico 25T
SPMSR515	SR515 DSMR 5 CH Receiver	SR515 DSMR 5-Kanal-Empfänger	Récepteur 5 canaux SR515 DSMR	SR515 DSMR Ricevitore a 5 canali

Part #	Description	Beschreibung	Description	Descrizione
SPMSSX117AX	SX117AX Micro Servo Metal Gear/Case, 250mm Lead	SX117AX Mikro Metallgetriebeservo	Servo à engrenages métalliques Micro SX117AX	SX117AX Micro Servo, ingranaggio metallico
SPMXSE1070	FIRMA 70A Brushed Smart WP ESC	70 Amp Geschwindigkeitsregler	ESC 70 Amp Firma	Firma ESC 70 Amp
TLR245016	M3 Flanged Lock Nuts (10)	M3 Sicherungsmuttern mit Flansch (10)	Contre-écrous à collet M3 (10)	Dadi flangiati M3 (10)
TLR5900	Button Head Screws, M3 x 5mm (10)	Rundkopfschraube, M3x5mm (10)	Vis à tête bombée, M3x5mm (10)	Vite a testa tonda M3x5mm (10)
TLR5907	Button Head Screws, M3 x 40mm (4)	Rundkopfschraube, M3x40mm (4)	Vis à tête bombée, M3x40mm (4)	Vite a testa tonda M3x40mm (4)
TLR6289	Set Screw, M3 x 5mm (10)	Stellschraube, M3 x 5mm (10)	Vis de fixation M3 x 5mm (10)	Vite di fermo M3 x 5mm

## OPTIONAL PARTS / OPTIONALE TEILE / PIÈCES EN OPTION / PARTI OPZIONALI

Part #	Description	Beschreibung	Description	Descrizione
AXI-2191	ASD Parts Set Complete: AXP8	Kompletter ASD-Teilesatz: AXP8	Ensemble de pièces ASD complet : AXP8	Set parti ASD completo: AXP8
AXI-2194	Body Panel Set, Aluminum: Gilamon AXP8	Karosserieteilesatz, Aluminium: Gilamon AXP8	Ensemble de panneaux de carrosserie, en aluminium : Gilamon AXP8	Set pannelli carrozzeria, alluminio: Gilamon AXP8
AXI-2195	Transmission Motor Plate, Aluminum, AT6: AXP8	Getriebe-Motorplatte, Aluminium, AT6: AXP8	Plaque moteur de transmission, en aluminium, AT6 : AXP8	Piastra motore di trasmissione, alluminio, AT6: AXP8
AXI-2199	32P Overdrive Ring/Pinion 13T/38T (6.30:1): AXP8	32P Overdrive Ring/Ritzel 13T/38T (6.30:1): AXP8	Anneau/pignon de surmultiplication 32P 13T/38T (6.30:1) : AXP8	Corona/Pignone Overdrive 32P 13T/38T (6.30:1): AXP8
AXI-2200	Portal Knuckles (L/R), Brass (69.5g ea), AF16P: AXP8	Portal-Achsschenkel (L/R), Messing (69,5 g pro Stück), AF16P: AXP8	Rotules de portique (G/D), en laiton (69,5 g chacun), AF16P : AXP8	Fusi a snodo Portal (Sx/Dx), ottone (69,5 g cad.), AF16P: AXP8
AXI-2201	Portal Cvr & Wghts, Brass(122.4g,34.6g ea), AF16P: AXP8	Portal Cvr & Wghts, Messing (122,4 g, 34,6 g pro Stück), AF16P: AXP8	Cache et contrepoids de portique, en laiton (122,4 g, 34,6 g chacun), AF16P : AXP8	Coperchi e pesi Portal, ottone (122,4 g, 34,6 g cad.), AF16P: AXP8
AXI-2202	Steering Links Set, Titaniumm, AF16P: AXP8	Lenkgliedersatz, Titan, AF16P: AXP8	Ensemble tringleries de direction, en titane, AF16P : AXP8	Set tiranti sterzo, Titanio, AF16P: AXP8
AXI-2204	Front Upper/Lower Links Set, Titanium: AXP8	Satz obere/untere Verbindungsglieder vorne, Titan: AXP8	Ensemble tringleries de direction avant supérieur/ inférieur, en titane : AXP8	Set tiranti anteriori sup./inf., titanio: AXP8
AXI-2205	Rear Upper/Lower Links Set, Titanium: AXP8	Satz obere/untere Verbindungsglieder hinten, Titan: AXP8	Ensemble tringleries de direction arrière supérieur/ inférieur, en titane : AXP8	Set tiranti posteriori sup./inf., titanio: AXP8
AXI-2206	Steering Axle, Assembled, AF16P: AXP8	Lenkungsachse, montiert, AF16P: AXP8	Essieu de direction, assemblé, AF16P : AXP8	Assale di sterzo, assemblato, AF16P: AXP8
AXI-2207	Rear Upper/Lower 4WS Links Set, Titanium: AXP8	Hintere obere/untere 4WS-Verbindungsglieder, Titan: AXP8	Ensemble tringleries de direction 4WS arrière supérieur/inférieur, en titane : AXP8	Set tiranti posteriore sup./inf. 4WS, titanio: AXP8
AXI-2208	32P Portal Gears Underdrive 12/29T (11.5%), AF16P: AXP8	32P Portal-Untersteuerungsgetriebe 12/29T (11,5 %), AF16P: AXP8	Engrenages de portique de sous-multiplication 32P 12/29T (11,5 %), AF16P : AXP8	Ingranaggi Portal Underdrive 32P 12/29T (11,5%), AF16P: AXP8
AXI-2209	32P Portal Gears Overdrive 14/27T (11%), AF16P: AXP8	32P Portal-Übersteuerungsgetriebe 14/27T (11 %), AF16P: AXP8	Engrenages de portique de surmultiplication 32P 14/27T (11 %), AF16P : AXP8	Ingranaggi Portal Overdrive 32P 14/27T (11%), AF16P: AXP8
AXI-2225	Shock Tuning and Rebuild Kit, IS10: AXP8	Stoßdämpfer Tuning und Umbausatz, IS10: AXP8	Ensemble de reconstruction et de réglage des amortisseurs, IS10 : AXP8	Kit tuning e ricostruzione ammortizzatori, IS10: AXP8
AXI-2858	Front Upper Link Mount, Aluminum, AF16P: AXP8	Oberlenkerhalterung vorne, Aluminium, AF16P: AXP8	Support de bras supérieur avant, en aluminium, AF16P : AXP8	Supporto tiranti anteriori superiori, Alluminio, AF16P: AXP8
AXI232046	Aluminum Hex Hub, 12mm, Hard Anodized: RBX10	Aluminium-Sechskantnabe, 12 mm, harteloxiert: RBX10	Moyeu hexagonal en aluminium, 12 mm, à anodisation dure : RBX10	Mozzo esagonale in alluminio, 12 mm, anodizzato: RBX10
AXIC0834	Aluminum Servo Horn 23T	Aluminium-Servohorn, 23T	Renvoi de commande du servo en aluminium 23T	Squadretta servo alluminio, 23T
AXIC0836	Aluminum Servo Horn 25T	Aluminium-Servohorn, 25T	Renvoi de commande du servo en aluminium 25T	Squadretta servo alluminio, 25T
AXIC2015	2.2 Ripsaw Tires X Compound (2)	2.2 Ripsaw-Räder X Compound (2)	Pneus Ripsaw 2.2 X Compound (2)	Ruote 2.2 Ripsaw X Compound (2)
AXIC8137	2.2 Rebel Wheels 41mm Wide Chrm/Blk (2)	2.2 Rebel-Räder 41 mm breit chrom/schwarz (2)	Roues Rebel 2.2 41 mm de large chrome/noires (2)	Cerchi 2.2 Rebel 41 mm larghi Cromo/Nero (2)



Part #	Description	Beschreibung	Description	Descrizione
DYNT0500	Startup Tool Set: ECX/VTR/HPI	Startup-Werkzeugsatz: ECX/VTR/HPI	Ensemble d'outils de démarrage : ECX/VTR/HPI	Set attrezzi base: ECX/VTR/HPI
PRO1010714	Interco TSL SX S Swamper XL 2.2 G8 Truck Tire	Interco TSL SX S Swamper XL 2.2 G8 Truck-Reifen	Pneu camion Interco TSL SX S Swamper XL 2.2 G8	Ruota Interco TSL SX S Swamper XL 2.2 G8 Truck
PRO1013203	Hyrax 2.2 Predator Truck Tires (2) for F/R	Hyrax 2.2 Predator Truck-Reifen (2) für Vo/Hi	Pneus camion Hyrax 2.2 Predator (2) avant/arrière	Ruote Hyrax 2.2 Predator Truck (2) per ant./post.
PRO1013214	Hyrax 2.2 G8 Truck Tire (2)	Hyrax 2.2 G8 Truck-Reifen (2)	Pneus camion Hyrax 2.2 G8 (2)	Ruote Hyrax 2.2 G8 (2)
PRO1017814	1/10 Ibx Ultra Cmp G8 F/R 2.2 CrawlTire NoFm (2)	1/10 Ibx Ultra Cmp G8 Vo/Hi 2.2 CrawlTire NoFm (2)	Pneus Crawler sans mousse 2.2 avant/arrière G8 1/10 Ibx Ultra Cmp (2)	Ruote 1/10 Ibx Ultra Cmp G8 F/R 2.2 Crawler NoFm (2)
PRO1019103	Trencher 2.2 Predator Tires for F/R	Trencher 2.2 Predator Reifen für Vo/Hi	Pneus Trencher 2.2 Predator avant/arrière	Ruote Trencher 2.2 Predator per ant./post.
PRO1020314	1/10 MickeyThompson BajaProX G8 F/R 2.2 Crawlr (2)	1/10 MickeyThompson BajaProX G8 Vo/Hi 2.2 Crawlr (2)	Crawler 2.2 MickeyThompson BajaProX G8 1/10 avant/arrière (2)	Ruote 1/10 MickeyThompson BajaProX G8 ant./post. 2.2 Crawler (2)
PRO1022014	1/10 Hyrax LP G8 Front/Rear 2.2 Crawler Tires (2)	1/10 Hyrax LP G8 vorne/hinten 2.2 Crawler-Reifen (2)	Pneus Crawler 2.2 Hyrax LP G8 1/10 avant/arrière (2)	Ruote 1/10 Hyrax LP G8 Ant./Post. 2.2 Crawler (2)
PRO116614	Fr R Interco TSL Super Swamper 2.2 G8 Crawl Tire	Fr R Interco TSL Super Swamper 2.2 G8 Crawl-Reifen	Pneu Crawler Interco TSL Super Swamper 2.2 G8 avant/arrière	Ruota Interco TSL Super Swamper 2.2 G8 Crawler ant./post.
PRO280503	1/10 Impluse F/R 2.2 12mm Crawler Whls (2) Black	1/10 Impluse Vo/Hi 2.2 12 mm Crawler-Reifen (2) Schwarz	Roues Crawler 12 mm 2.2 Impluse 1/10 avant/arrière, noires (2)	Ruote 1/10 Impulse 2.2 12 mm Crawler ant./post. (2) Nero
PRO617600	2.2 Dual Stage Closed Cell Crawl Foam Insert (2)	2.2 Dual Stage Closed Cell Crawl-Schaumstoffeinsatz (2)	Fond en mousse Crawler à cellules fermées Dual Stage 2.2 (2)	Inserto schiuma 2.2 cella chiusa doppio stadio (2)
SPMSS6230	S6230 Ultra Torq Mid Speed Digital WP Metal Servo	S6230 U-T/M-S Digitaler WP Servo	Servo étanche numérique U-T / M-S S6230	Servo digitale S6230 U-T/M-S imp
SPMSS6240	S6240 High Torq High Speed Digital WP Metal Servo	S6240 U-T/M-S Digitaler WP Servo	Servo étanche numérique U-T / M-S S6240	Servo digitale S6240 U-T/M-S imp
SPMSS6250	S6250 Ultra Torque High Speed Digi WP Metal Servo	S6250 U-T / H-S Digitaler HV WP Servo	Servo numérique étanche haute tension U-T / H-S S6250	Servo digitale S6250 U-T/H-S imp HV
SPMSS6285	1/8 HighTorque Race Servo	1/8 HighTorque Race Servo	Servo de course à couple élevé 1/8	Servo gara alta coppia 1/8
SPMSS7110	Spektrum 1/10 Servo Winch	Spektrum 1/10 Servo Winde	Bobine de servo 1/10 Spektrum	Argano servo Spektrum 1/10
SPMSSX117	SX117 Micro Servo Metal Gear/Case	SX117 Mikro Metallgetriebeservo	Servo à engrenages métalliques Micro SX117	SX117 Micro Servo, ingranaggio metallico
SPMSSX117AX	SX117AX Micro Servo Metal Gear/Case, 250mm Lead	SX117AX Mikro Metallgetriebeservo	Servo à engrenages métalliques Micro SX117AX	SX117AX Micro Servo, ingranaggio metallico
SPMX-1016	UBEC 10A (2-6S)	UBEC 10 A (2-6S)	UBEC 10 A (2-6S)	UBEC 10A (2-6S)
SPMXSEM1040B	Firma 2 in 1 Brushless Crawler Motor ESC: 2300Kv	Firma 2-in-1 Bürstenloser Crawler-Motor Geschwindigkeitsregler: 2300 Kv	Variateur ESC/moteur sans balais 2-en-1 Crawler Firma : 2 300 kV	Motore ESC 2 in 1 Firma Brushless Crawler: 2300 Kv
SPMXSEMC08	Firma Sensored 1/10th Crawler Power System w/Smart	Firma Sensored 1/10 Crawler Power System Smart	Système d'alimentation Crawler 1/10 Firma avec capteurs et Smart	Sistema di potenza Firma con sensori 1/10 Crawler con Smart
SPMXSEMC09	Firma 60A BL Smart ESC 2800Kv Sense Mot Crawl Com	Firma 60A BL Smart ESC 2800 Kv Sense Mot Crawl Com	Ensemble Crawler moteur avec capteurs sans balais 2 800 kV/ variateur ESC Smart sans balais 60 A Firma	Combo ESC motore Firma 60 A BL Smart 2800 Kv con sensori Crawler

**RECOMMENDED // EMPFOHLEN // RECOMMANDÉ // CONSIGLIATO**

Part #	Description	Beschreibung	Description	Descrizione
SPMX-1047	Smart G2 Trail Pro 3400mAh 3S 11.1V 50C LiPo w/ IC3	G2 3400mAh 3S 11,1V Smart 50C; IC3	G2 3400mAh 3S 11,1V Smart 50C; IC3	G2 3400mAh 3S 11,1V Smart 50C; IC3
SPMX22003S50	2200mAh 3S 11.1V 50C Smart LiPo Battery; IC3	2200mAh 3S 11,1V Smart 50C; IC3	2200mAh 3S 11,1V Smart 50C; IC3	2200mAh 3S 11,1V Smart 50C; IC3
SPMX223S100	2200mAh 3S 11.1V Smart G2 LiPo 100C; IC3	2200mAh 3S 11,1V Smart G2 100C; IC3	2200mAh 3S 11,1V Smart G2 100C; IC3	2200mAh 3S 11,1V Smart G2 100C; IC3
SPMX223S30	2200mAh 3S 11.1V Smart G2 LiPo 30C; IC3	2200mAh 3S 11,1V Smart G2 30C; IC3	2200mAh 3S 11,1V Smart G2 30C; IC3	2200mAh 3S 11,1V Smart G2 30C; IC3
SPMX223S50	2200mAh 3S 11.1V Smart G2 LiPo 50C; IC3	2200mAh 3S 11,1V Smart G2 50C; IC3	2200mAh 3S 11,1V Smart G2 50C; IC3	2200mAh 3S 11,1V Smart G2 50C; IC3
SPMX32003S30	3200mAh 3S 11.1V Smart LiPo 30C; IC3	3200mAh 3S 11,1V Smart 30C; IC3	3200mAh 3S 11,1V Smart 30C; IC3	3200mAh 3S 11,1V Smart 30C; IC3
SPMX40003S30	4000mAh 3S 11.1V Smart LiPo Battery 30C; IC3	4000mAh 3S 11,1V Smart 30C; IC3	4000mAh 3S 11,1V Smart 30C; IC3	4000mAh 3S 11,1V Smart 30C; IC3
SPMX43S30	4000mAh 3S 11.1V Smart G2 LiPo Battery 30C; IC3	4000mAh 3S 11,1V Smart G2 30C; IC3	4000mAh 3S 11,1V Smart G2 30C; IC3	4000mAh 3S 11,1V Smart G2 30C; IC3
SPMX53S100H3	5000mAh 3S 11.1V Smart G2 Hard Case LiPo 100C IC3	5000mAh 3S 11,1V Smart G2 100C; IC3	5000mAh 3S 11,1V Smart G2 100C; IC3	5000mAh 3S 11,1V Smart G2 100C; IC3
SPMX53S30H3	5000mAh 3S 11.1V Smart G2 LiPo 30C Hard Case; IC3	5000mAh 3S 11,1V Smart G2 30C; IC3	5000mAh 3S 11,1V Smart G2 30C; IC3	5000mAh 3S 11,1V Smart G2 30C; IC3
SPMX53S50H3	5000mAh 3S 11.1V Smart G2 LiPo 50C Hard Case; IC3	5000mAh 3S 11,1V Smart G2 50C; IC3	5000mAh 3S 11,1V Smart G2 50C; IC3	5000mAh 3S 11,1V Smart G2 50C; IC3
SPMXC2000	Smart S2100 G2 AC Charger, 2x100W	Smart S2100 G2 Wechselstrom-Ladegerät, 2x100 W	Chargeur c.a. Smart G2 S2100, 2 x 100 W	Caricabatt Smart G2 S2100 CA, 2x100 W
SPMXC2010	Smart S2200 G2 AC Charger, 2x200W	Smart S2200 G2 Wechselstrom-Ladegerät, 2x2100 W	Chargeur c.a. Smart G2 S2200, 2 x 200 W	Caricabatt Smart G2 S2200 CA, 2x200 W
SPMXC2050	S155 55W AC G2 Smart Charger	Smart S155 G2 Wechselstrom-Ladegerät 55W	Chargeur c.a. Smart G2 S155, 55 W	Caricabatt Smart G2 S155 CA, 55 W
SPMX-1033	Smart Powerstage Surface Bundle: 5000mAh 3S 50C LiPo Battery (IC3) / 100W S100 Charger	Smart Oberflächen-Leistungsteilpaket: 5000 mAh 3S 50C LiPo Akku (IC3) / 100 W S100 Ladegerät	Ensemble de surface Smart Powerstage : Batterie Li-Po 5 000 mAh 3S 50C (IC3) / chargeur 100 W S100	Smart Powerstage Bundle superficie: Batteria 5000 mAh 3S 50C LiPo (IC3) / Caricabatteria 100 W S100
SPM6125	DX6C TX w/SR315 RX	DX6 Rugged DSMR TX mit SR315 RX	Émetteur DX6 robuste DSMR avec récepteur SR315	Tx DX6 Rgd DSMR con RX SR315
SPM6420	iXSR Surface Transmitter with SR515 Receiver	iXSR-Oberflächensender mit SR515-Empfänger	Émetteur de surface iXSR avec récepteur SR515	Trasmittente di superficie iXSR con Ricevitore SR515
SPMR5025	DX5 Pro 2021 DSMR TX Only	DX5 Pro 2021 DSMR nur TX	DX5 Pro 2021 DSMR TX uniquement	Solo DX5 Pro 2021 DSMR TX
SPMR6215G	DX6 Rugged 6 Channel DSMR Transmitter Only, Green	Nur DX6 Rugged DSMR TX, Grün	Émetteur uniquement DX6 robuste DSMR, vert	DX6 Rugged DSMR solo Tx, verde
SPMR6215O	DX6 Rugged 6 Channel DSMR Transmitter Only, Orange	Nur DX6 Rugged DSMR TX, Orange	Émetteur uniquement DX6 robuste DSMR, orange	DX65 Rugged DSMR solo Tx, aranc